

Notice

Rafale C

Ech 1:144

Page 2



Rafale_144_N_FDM

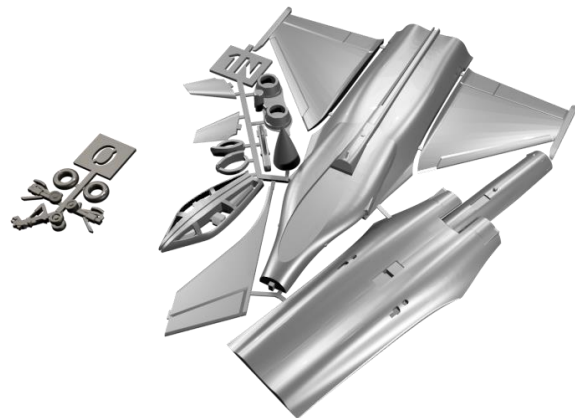

Page 3/7



Rafale_144_A_FDM

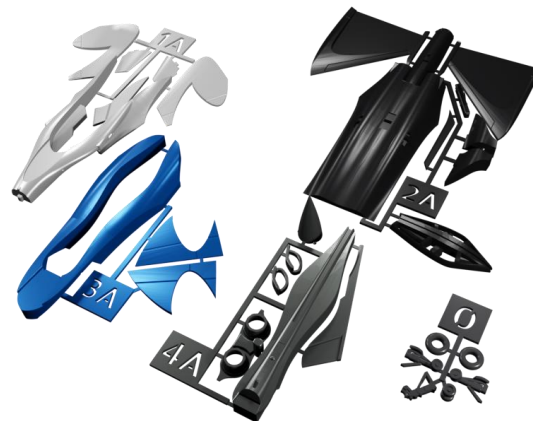

Page 8/11



Rafale_144_C_FDM

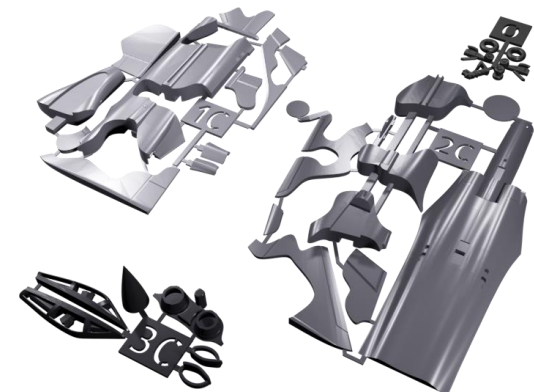

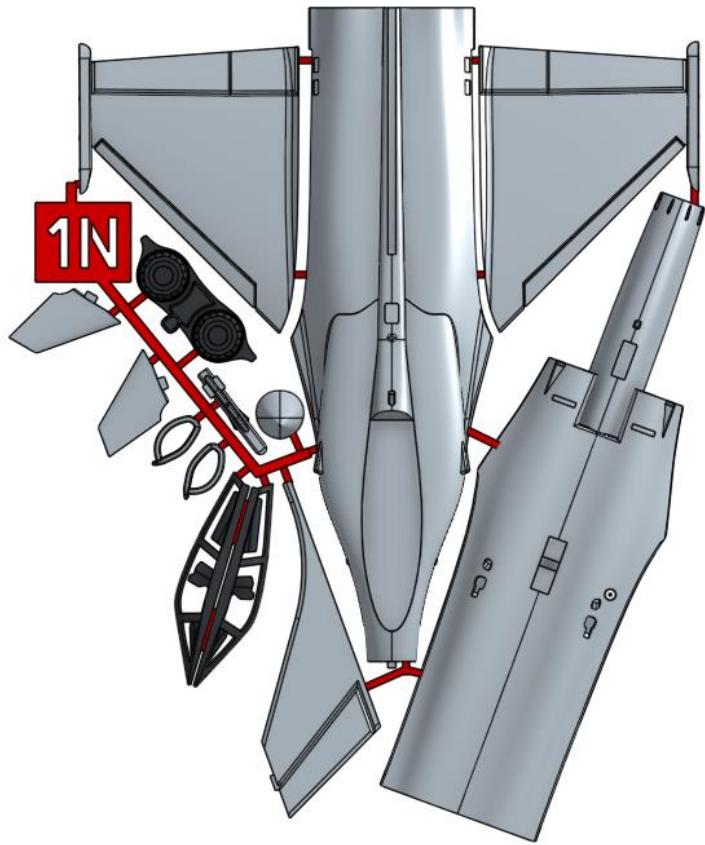

angles view

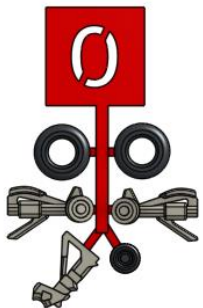
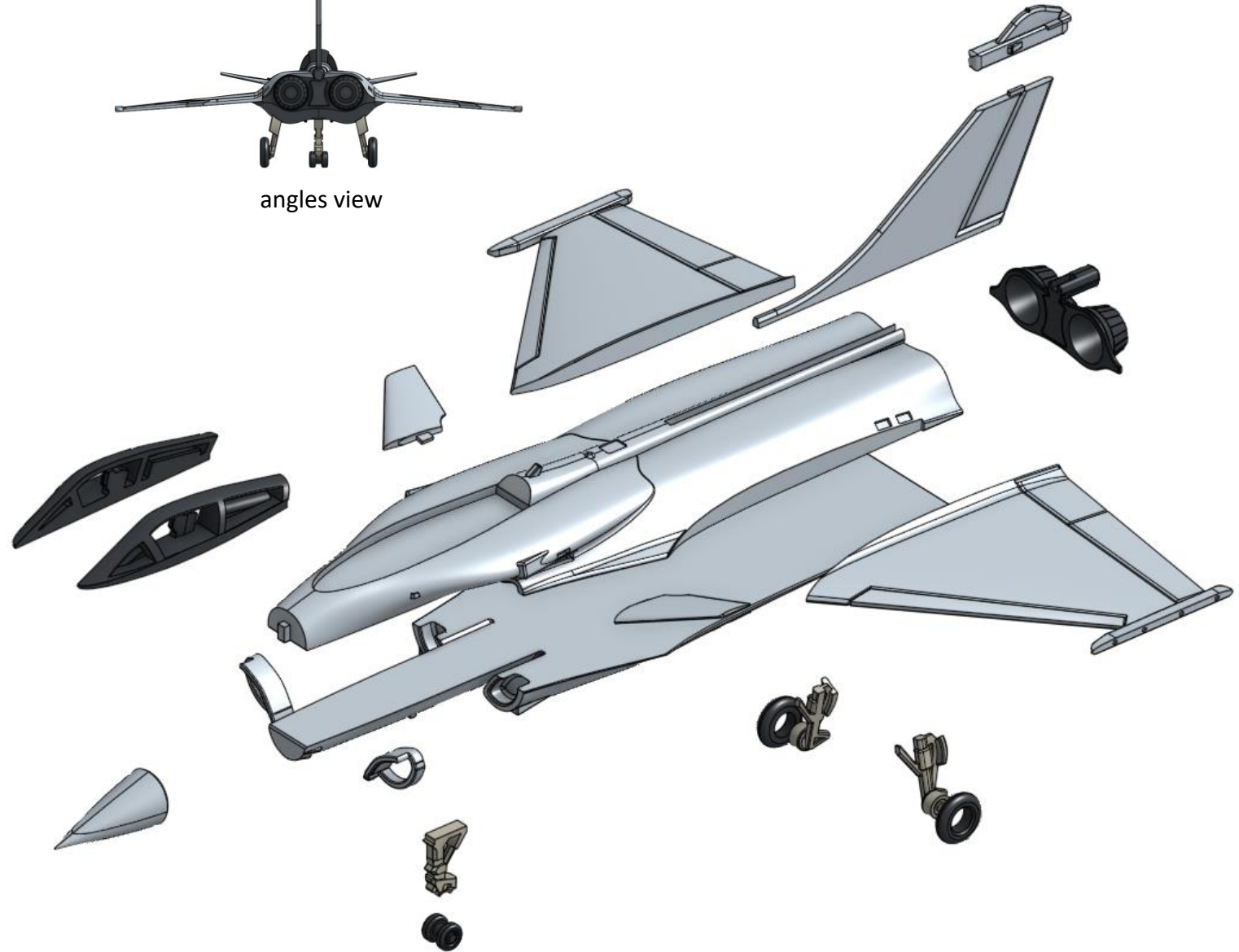

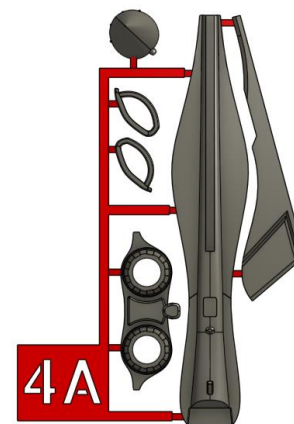
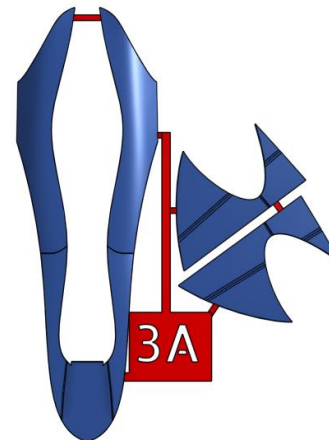
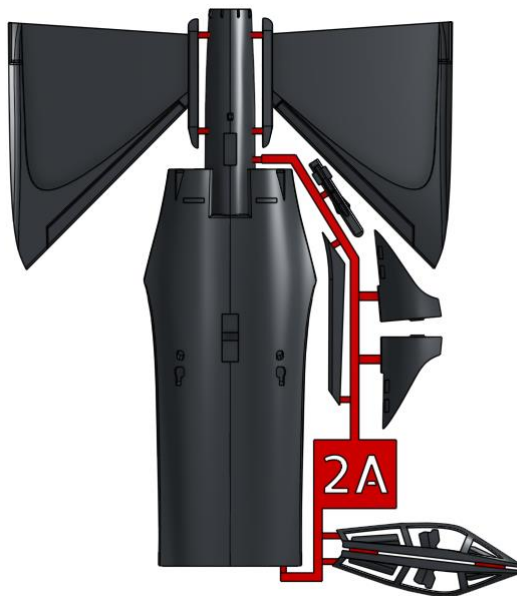
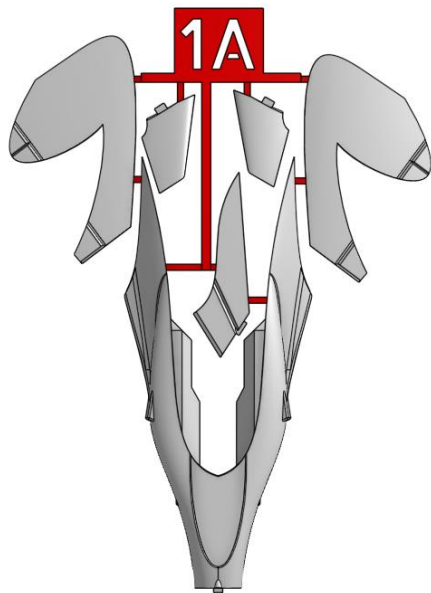
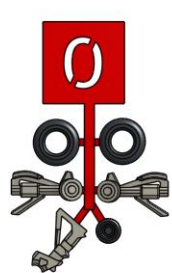

1

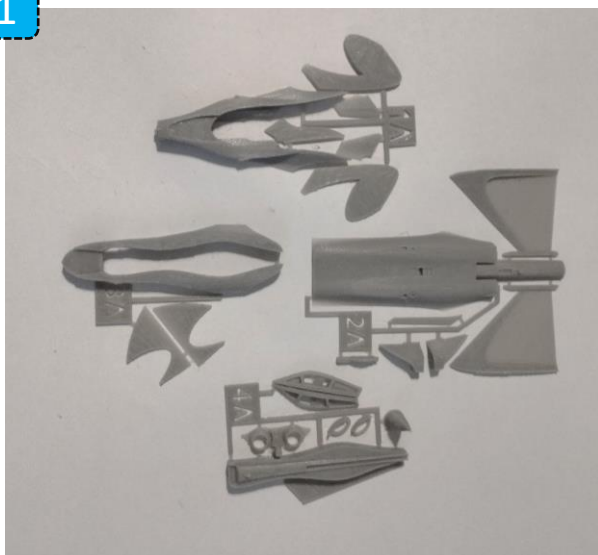

Sanded & deburred parts



Landing Gears option

2



Pre painted with theme
or colored printed parts

3

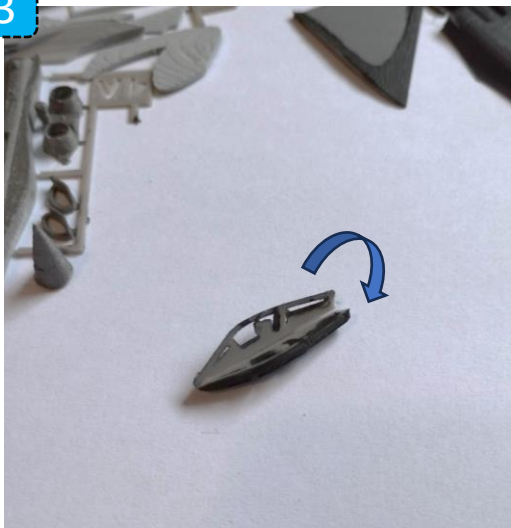

you can fold the two pieces on top of each other for glue alignment

5

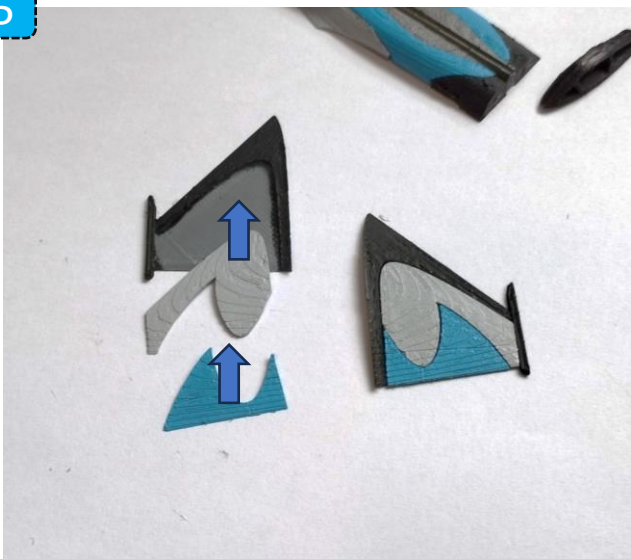

4

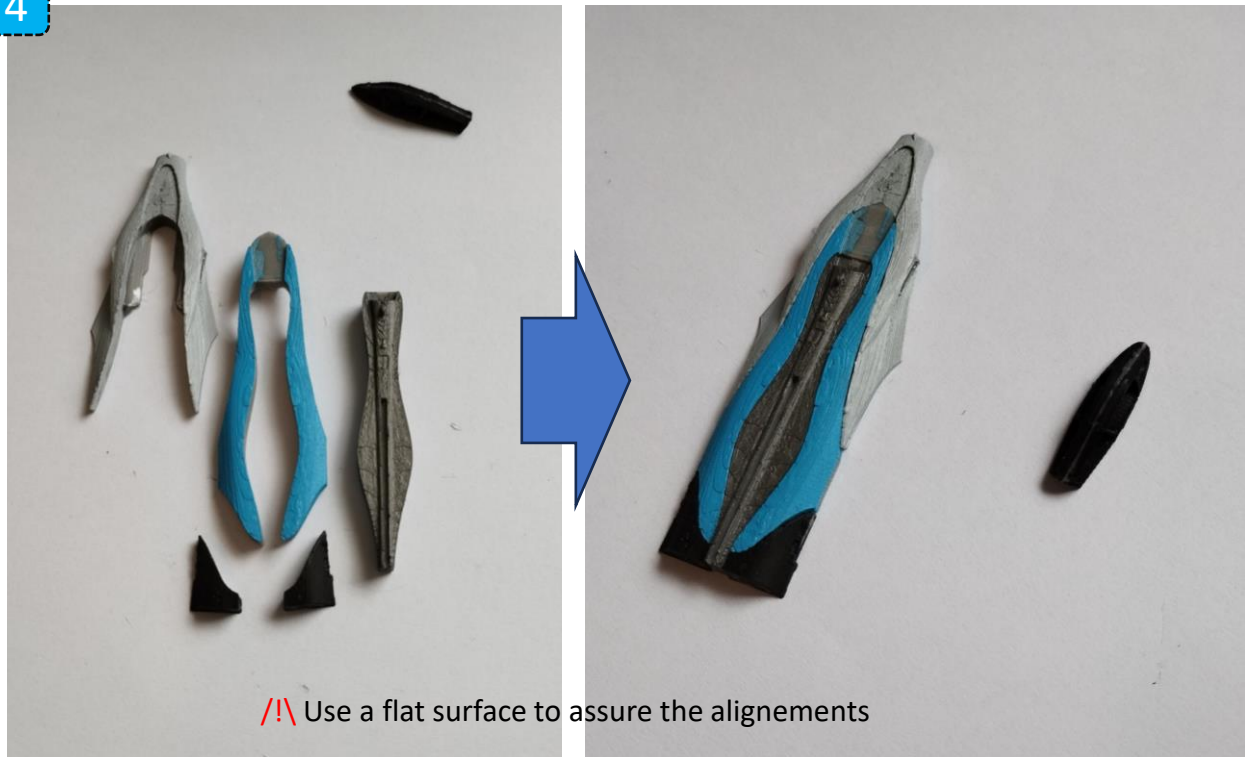

6

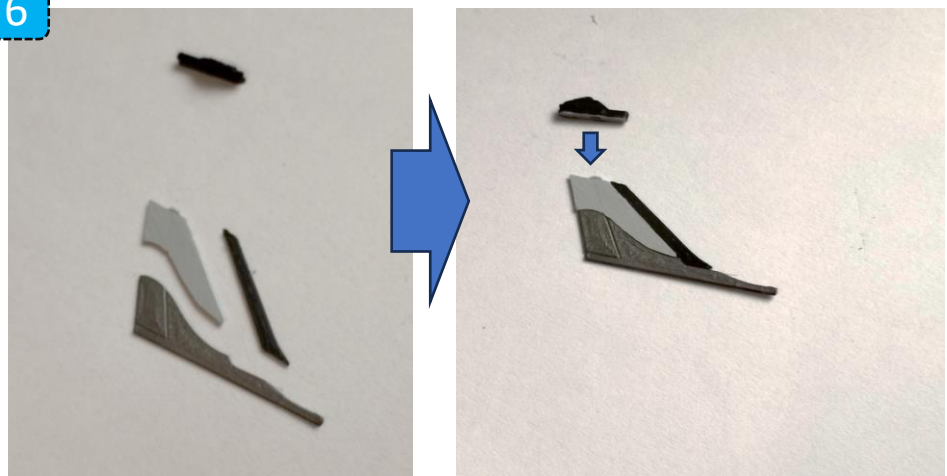

7

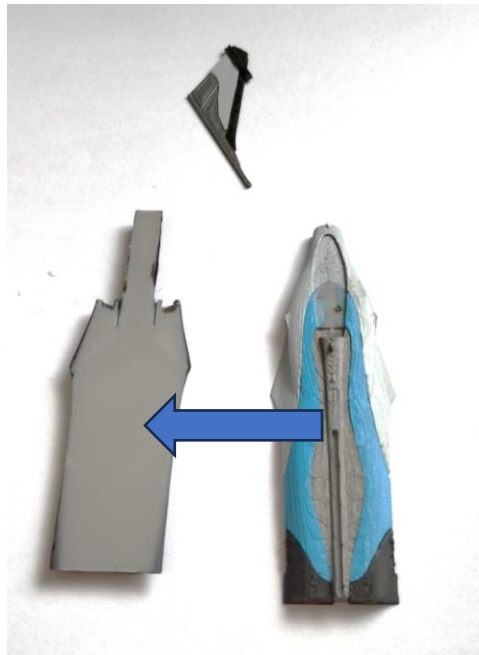

8

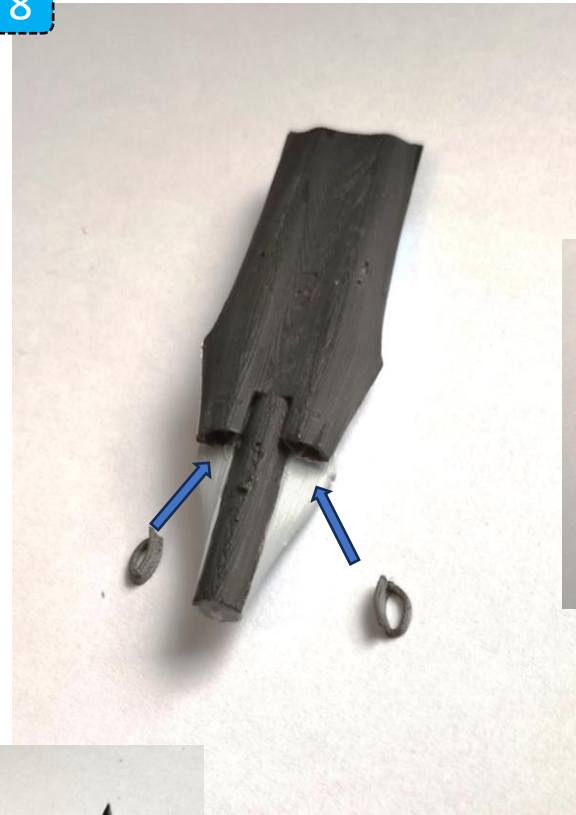

9

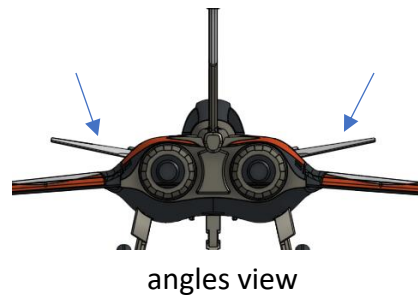
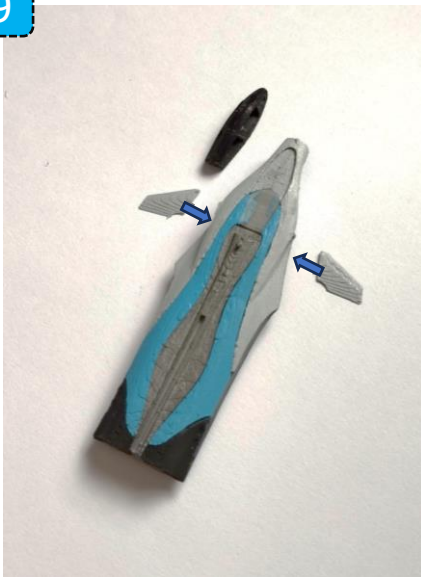

10



11



angles view



12

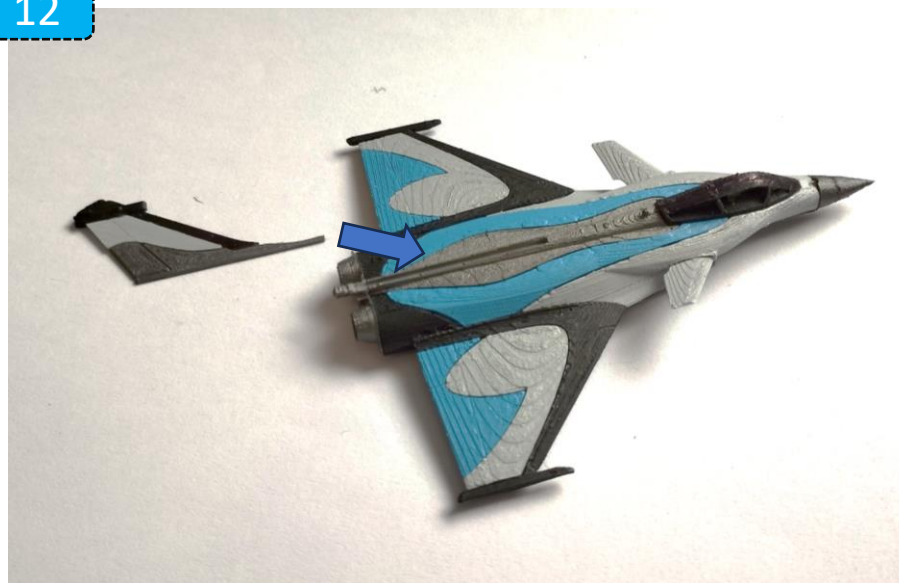

13A

Landing gears Option

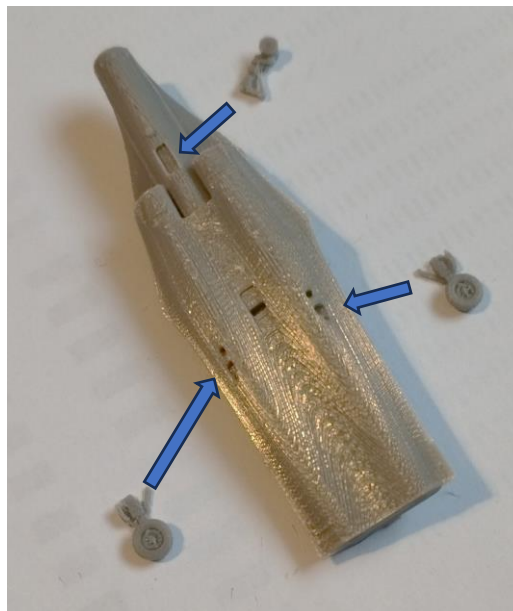
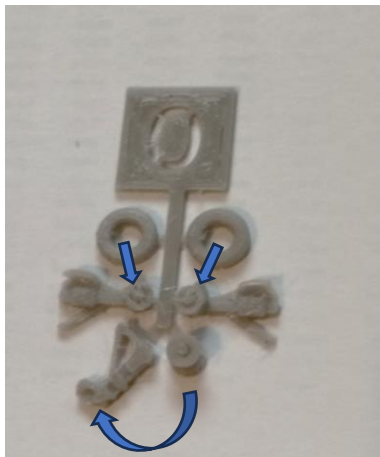

13B

Stand Option

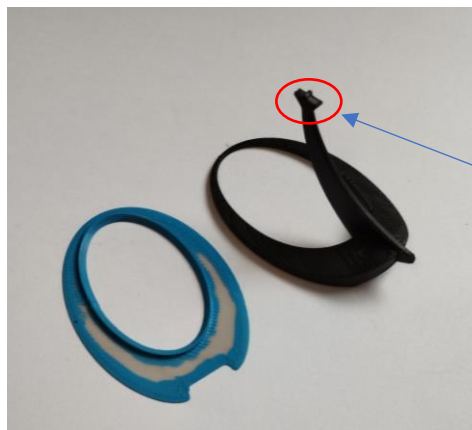

Stand position hole

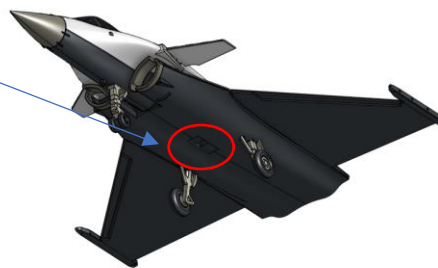

End

2



3

Use a flat surface to assure the alignment

Print supports to cut/remove

⚠ Use a flat surface to assure the alignments

4

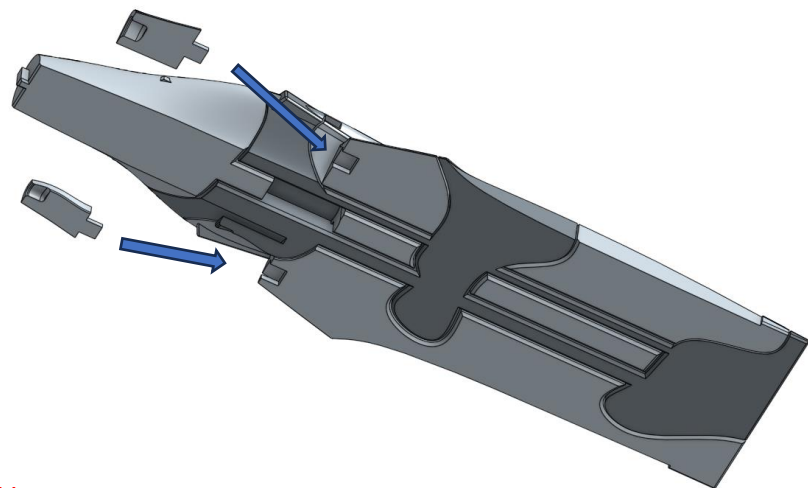

⚠ Use a flat surface to assure the alignements

5

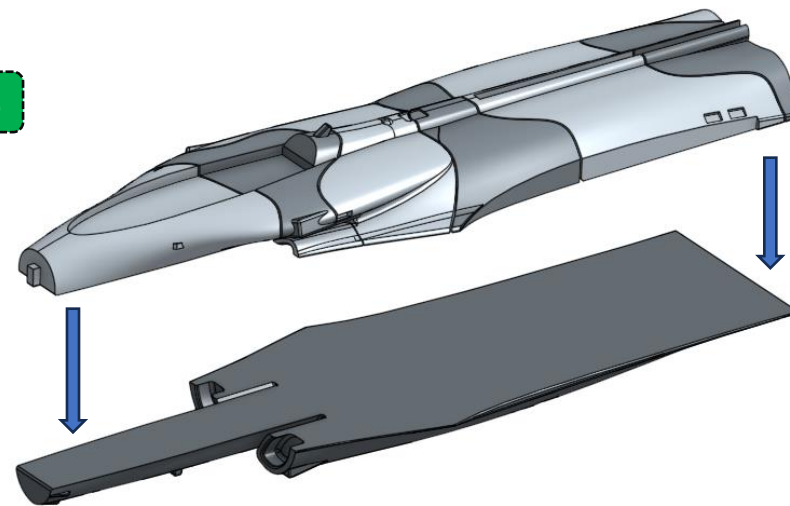

6

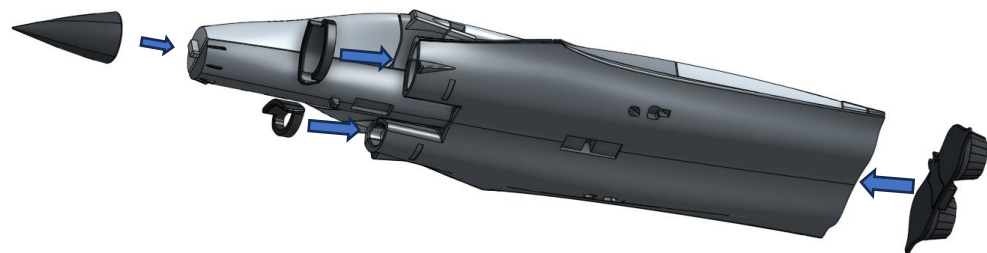

7

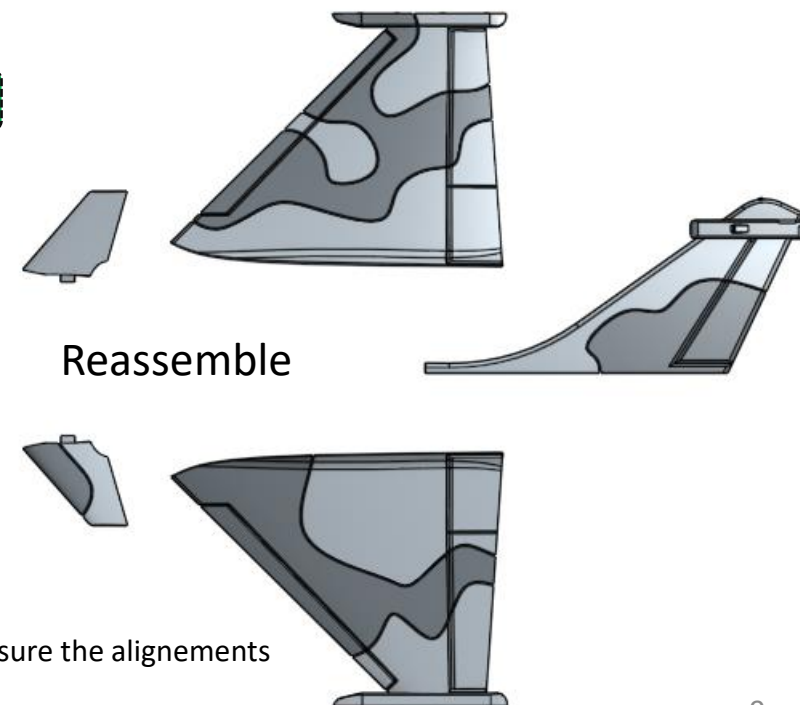

⚠ Use a flat surface to assure the alignements

8

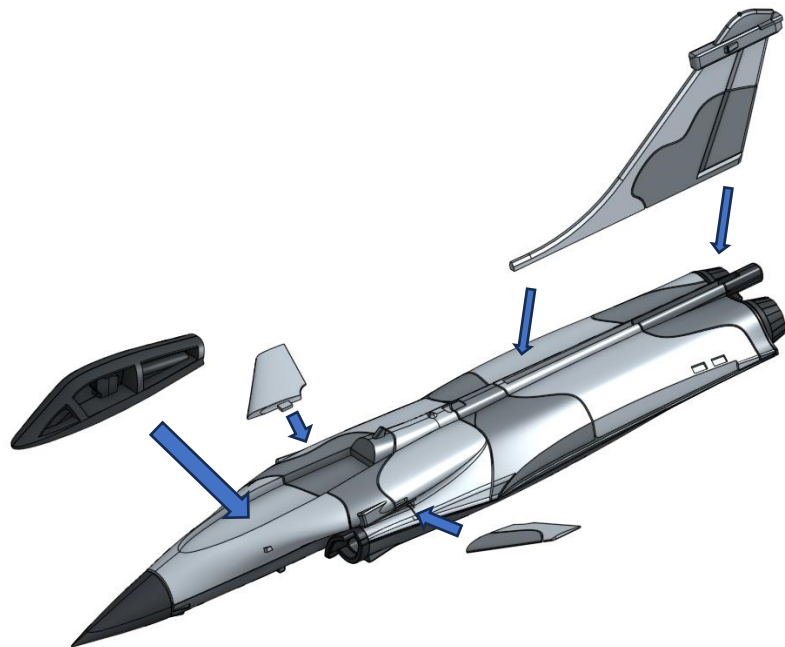

9

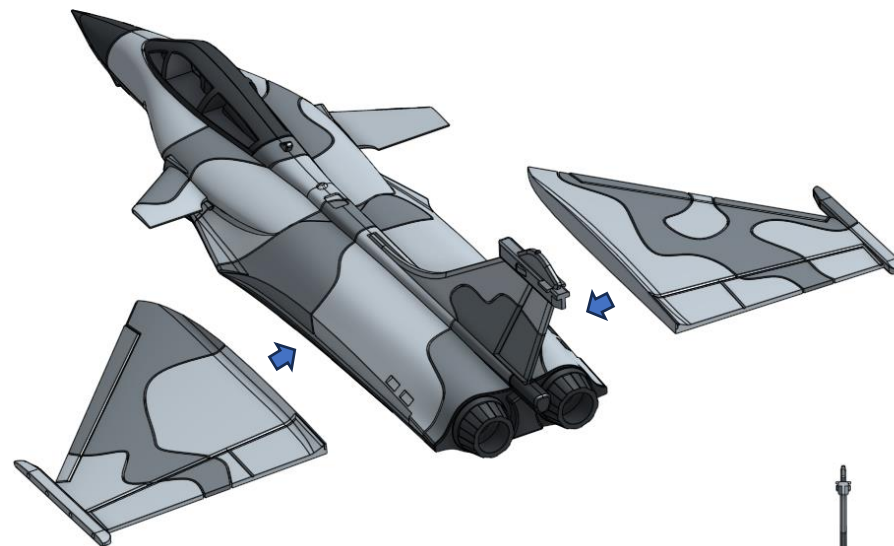

angles view

10

Landing gears Option

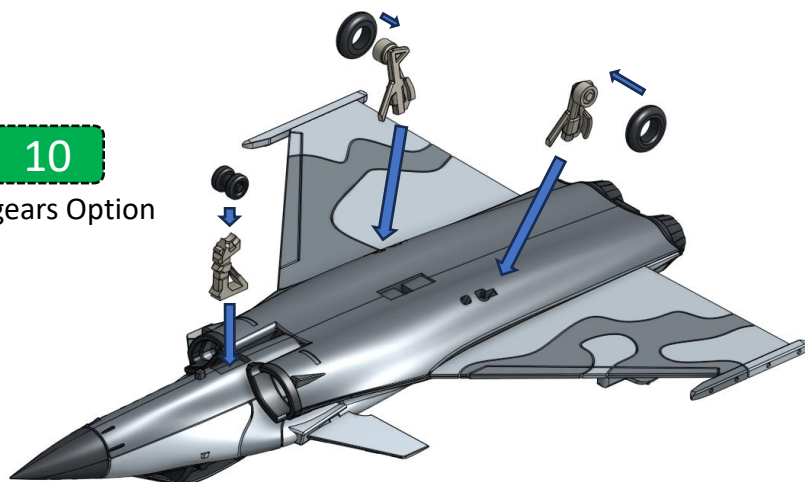

11

Stand Option

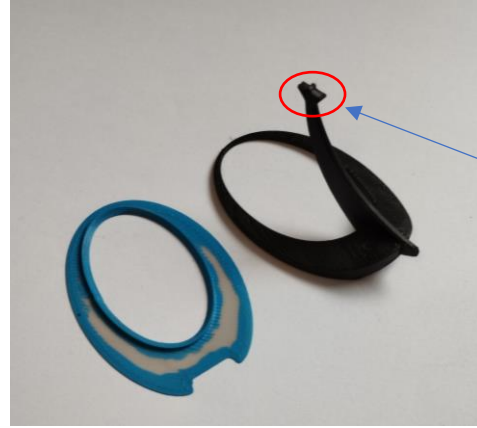

Stand position hole

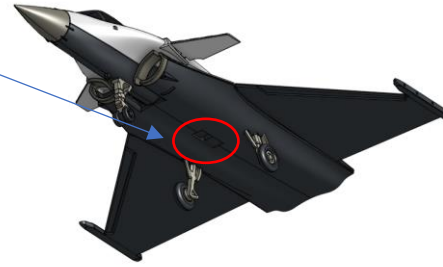

End